

KEEP IT SECURE

QUALITY IT SECURITY PRODUCTS

LAP Series Instructions

Accessories:
Handle
2 x M5 Bolts
M5 Allen key

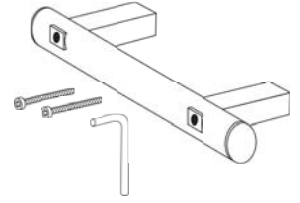

≡ 35KG+

1

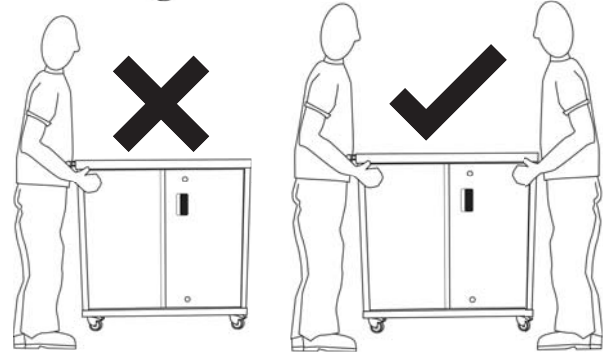

Your unit has been preassembled during manufacture to speed up setup time.

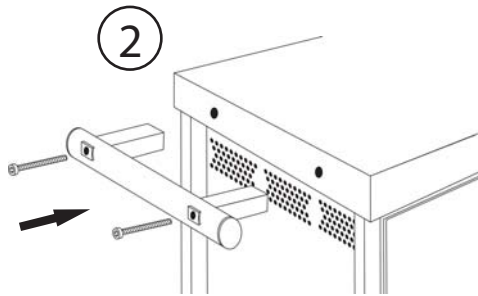

You should receive the unit with just the following push handle that will need attaching using the tool provided. The push handle can be attached at either end of the unit. Please see attachment above.

3

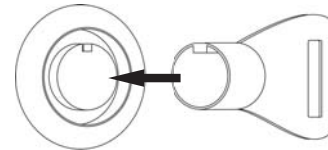

Locking Trolley:
Insert Key into position as illustrated, turn clockwise

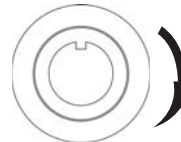

Unlocking Trolley:
Insert Key into position as illustrated, turn anti clockwise

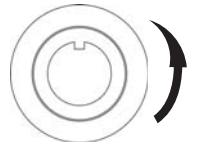

Lap 10 = Turn 3/4
Lap 20/30 = Turn 1 1/4

Lap 10 = Turn 3/4
Lap 20/30 = Turn 1 1/4

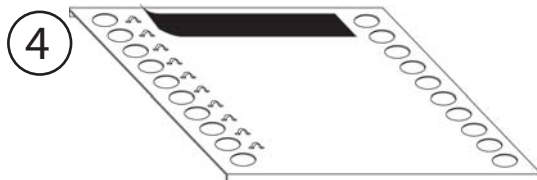

If you wish you can use the clips and double sided straps to position on the shelves according to your laptop dimensions to ensure cable tidiness

Keys are unique to each unit, please keep them in a safe place.

5

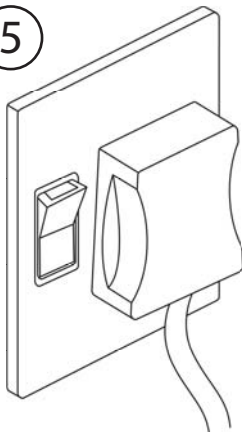

Connect your Chosen LAP Series to the nearest power socket for charging and ensure that the charging LED is active.

6



That's it, your product is now ready for use